



Padre Anchieta Footbridge

San Cristóbal de la Laguna, Tenerife / 2018

Structural type
Characteristics
Client
Scope

structural steel footbridge
circular elevated structure
Cabildo Insular de Tenerife
tender design and detailed design

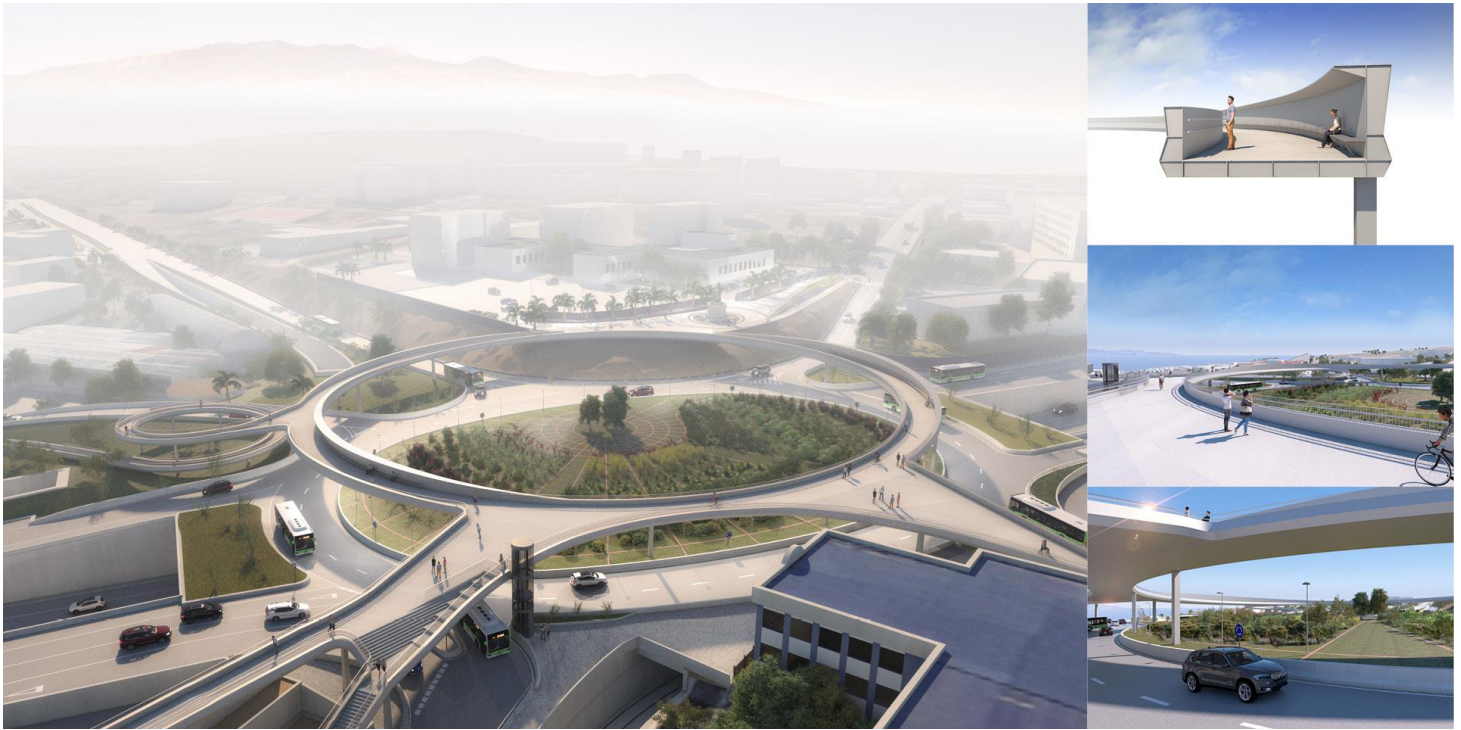

FHECOR Ingenieros Consultores has been awarded the contract for the elaboration of the Construction Project of the "Pedestrian Footbridge in Padre Anchieta connection of TF-5 Highway", located in San Cristobal de La Laguna, in Tenerife. The FHECOR design was the winner of the competition of ideas held by the Island Council of Tenerife. Moreover, together with TRAZAS INGENIERIA, S.L, FHECOR will ensure the control and supervision, during execution, of multiple works managed by the Technical Services of Roads and Landscape, in which is included the Padre Anchieta footbridge.

Nowadays, a large vehicle flow makes use of the Padre Anchieta connection, which usually leads to significant traffic jams in its roundabout access branches at certain moments of the day. Furthermore, the aforementioned vehicle flow is also affected by the dense pedestrian flow, since the connection is located in an important pedestrian route which connects the urban area with the University. The FHECOR design ensures an effective interrelation between cars and people by means of an elevated infrastructure for pedestrians, solving the mobility problem existing between them now.

From the structural point of view, the proposed solution mainly consists of a curved ring-shaped continuous beam supported by means of a system of isolated supports. Circumferential shape of the footbridge provides its location with a visually dynamic continuous geometric space.



C/ Barquillo 23, 2º | 28004 Madrid | España
T. (+34) 917 014 460 | F. (+34) 915 327 864
www.fhecor.com | fhecor@fhecor.es